

greenworks®

MO60L810

EN	LAWN MOWER	OPERATOR MANUAL
FR	TONDEUSE	MANUEL D'UTILISATION
ES	CORTACÉSPED	MANUAL DEL OPERADOR

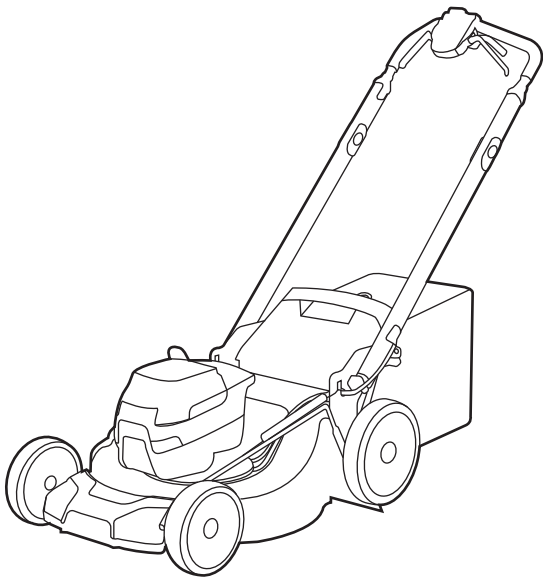

LMC40001

www.greenworkstools.com

1	Introduction.....	4	4.9	Start the product.....	11
1.1	Product description.....	4	4.10	Activate Turbo Boost (Temporarily Increased Cutting Speed).....	12
1.2	Intended use.....	4	4.11	Operate the self-propelled drive system.....	12
1.3	Overview.....	4	4.12	LED Headlights.....	12
1.4	Symbols on the product.....	4	4.13	Stop the product.....	12
1.5	California Proposition 65.....	4	4.14	Recommendations for Effective Lawn Mowing.....	13
2	Safety.....	5	5	Maintenance.....	14
2.1	Safety definitions.....	5	5.1	Maintenance schedule.....	14
2.2	Lawnmower safety warnings.....	5	5.2	General inspection.....	14
2.3	Safety features on the product.....	7	5.3	Clean the product.....	14
2.4	Check the cutting deck.....	7	5.4	Clean the battery and battery charger.....	15
2.5	Grass catcher.....	7	5.5	Examine the cutting equipment....	15
2.6	Blade Activation Lever.....	7	6	Transportation, storage, and disposal.....	17
2.7	Battery safety.....	7	6.1	Set the product in transportation position.....	17
2.8	Battery charger safety.....	7	6.2	Transportation.....	17
2.9	Safety instructions for maintenance.....	7	6.3	Disposal of the battery, battery charger, and product.....	17
3	Assembly.....	8	7	Troubleshooting.....	18
3.1	Install the upper handle.....	8	8	Technical data.....	18
4	Operation.....	9	9	Limited warranty.....	19
4.1	Before using the product.....	9			
4.2	Adjust the Handlebar Position.....	9			
4.3	Set the cutting height.....	9			
4.4	Use the product with grass catcher.....	10			
4.5	Switch to mulching mode.....	10			
4.6	Switch to side discharging mode...	11			
4.7	Mowing without a grass catcher or mulch plug	11			
4.8	Connect the battery to the product.....	11			

1 INTRODUCTION

1.1 PRODUCT DESCRIPTION

This product is a battery-powered self-propelled rotary lawn mower that features a mulching function and is equipped with a detachable grass catcher.

We are committed to continuously improving our products, and reserve the right to modify the design and appearance without prior notice.

1.2 INTENDED USE

This product is designed to cut and mulch different kinds of grass and weeds. It should not be used for any other tasks.

1.3 OVERVIEW

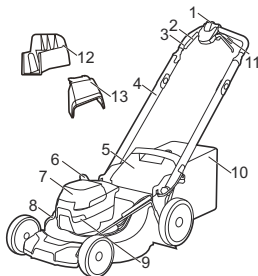

- 1 Power button
- 2 Blade activation lever
- 3 Upper handle
- 4 Lower handle
- 5 Rear door
- 6 Cutting height lever
- 7 Battery door
- 8 Side discharge door
- 9 LED Headlight
- 10 Grass catcher
- 11 Self-propelled drive lever
- 12 Mulch plug
- 13 Side discharge chute

1.4 SYMBOLS ON THE PRODUCT

Symbol	Explanation
	Precautions that involve your safety.
	To reduce the risk of injury, user must read instruction manual.
	Danger — Keep hands and feet away.
	WARNING — Beware of thrown objects — keep bystanders away.
	WARNING — Keep hand and feet away from the blades.
	WARNING — Disconnect all batteries before maintenance.

1.5 CALIFORNIA PROPOSITION 65

WARNING

THIS PRODUCT CONTAINS OR EMITS A CHEMICAL KNOWN TO THE STATE OF CALIFORNIA TO CAUSE CANCER OR BIRTH DEFECTS OR OTHER REPRODUCTIVE HARM.

2 SAFETY

2.1 SAFETY DEFINITIONS

Warnings, cautions, and notes are used to point out especially important parts of the manual.



WARNING

THERE IS A RISK OF INJURY OR DEATH FOR THE OPERATOR OR BYSTANDERS, IF THE INSTRUCTIONS IN THE MANUAL ARE NOT OBEYED.



CAUTION

THERE IS A RISK OF DAMAGE TO THE PRODUCT, OTHER MATERIALS, OR THE ADJACENT AREA, IF THE INSTRUCTIONS IN THE MANUAL ARE NOT OBEYED.

Note: Used to give more information that is necessary in a given situation.

2.2 LAWNMOWER SAFETY WARNINGS



WARNING

Read all safety warnings, instructions, illustrations and specifications provided with this lawnmower. Failure to follow all instructions listed below may result in electric shock, fire and/or serious injury.

Save all warnings and instructions for future reference.

1) Work area safety

- a) To avoid bystander contact with the moving blade or a thrown object injury, *keep the area of operation clear of all bystanders, particularly small children.* Stop the lawnmower and any attachment(s) if anyone enters the area. *Contact with the moving blade or thrown objects may result in serious personal injury or death.*
- b) Only operate the lawnmower in daylight or good artificial light. *Dark areas invite accidents.*
- c) Do not operate lawnmowers in explosive atmospheres, such as in the presence of flammable liquids, gases or dust. *Lawnmowers create sparks which may ignite the dust or fumes.*
- d) Do not use the lawnmower in bad weather conditions, especially when there is a risk of lightning. *This decreases the risk of being struck by lightning.*
- e) Thoroughly inspect the area where the lawnmower is to be used and remove all stones, sticks, wires, bones, and other foreign

objects. Thrown objects can cause personal injury.

2) Electrical safety

- a) Do not expose the lawnmower to rain or wet conditions. *Water entering a lawnmower may increase the risk of electric shock.*

3) Personal safety

- a) Use personal protective equipment. Always wear eye protection. *Protective equipment will reduce personal injuries.*
- b) Dress properly. Do not wear loose clothing or jewellery. Keep your hair and clothing away from moving parts. *Loose clothes, jewellery or long hair can be caught in moving parts.*
- c) While operating the lawnmower, always wear long trousers. *Exposed skin increases the likelihood of injury from thrown objects.*
- d) While operating the lawnmower, always wear non-slip and protective footwear. Do not operate the lawnmower when barefoot or wearing open sandals. *This reduces the chance of injury to the feet from contact with the moving blade*
- e) Prevent unintentional starting. Ensure the switch is in the off-position before connecting to power source and/or batteries, picking up or carrying the lawnmower. *Carrying a lawnmower with your finger on the switch or energising a lawnmower that has the switch on invites accidents.*
- f) Remove any adjusting key or wrench before turning the lawnmower on. *A wrench or a key left attached to a rotating part of the lawnmower may result in personal injury.*
- g) Keep proper footing and balance at all times. *This enables better control of the lawnmower in unexpected situations.*
- h) Stay alert, watch what you are doing and use common sense when operating a lawnmower. Do not use a lawnmower while you are tired or under the influence of drugs, alcohol or medication. *A moment of inattention while operating a lawnmower may result in serious personal injury.*
- i) Do not let familiarity gained from frequent use of lawnmower allow you to become complacent and ignore lawnmower safety principles. *A careless action can cause severe injury within a fraction of a second.*
- j) To avoid operator blade contact or a thrown object injury, stay in the operator zone behind the lawnmower handles. *Blade contact or thrown objects may result in serious personal injury*
- k) Do not touch blades and other hazardous moving parts while they are still in motion. *This reduces the risk of injury from moving parts..*

4) Lawnmower use and care

- a) Use the lawnmower and accessories in accordance with these instructions, taking into account the working conditions and the work to be performed. *Use of the lawnmower for operations different from those intended may result in a hazardous situation.*
- b) Before using the lawnmower, always visually inspect to see that the blade(s) and the blade(s) assembly are properly secured and not worn or damaged. *Loose, worn, or damaged parts may increase the risk of injury.*
- c) Keep guards and other safety devices in place, properly mounted, and in working order. *A guard or other safety device that is loose, damaged, or is not functioning correctly may result in personal injury.*
- d) Keep all cooling air inlets clear of debris. *Blocked air inlets and debris may result in overheating or risk of fire.*
- e) Do not use the lawnmower if the switch does not turn it on and off. *Any lawnmower that cannot be controlled with the switch is dangerous and must be repaired.*
- f) Do not operate the lawnmower in wet grass. Walk, never run. *This reduces the risk of slipping and falling which may result in personal injury.*
- g) Do not operate the lawnmower on excessively steep slopes. *This reduces the risk of loss of control, slipping and falling which may result in personal injury.*
- h) Do not force the lawnmower. Use the correct lawnmower for your application. *The correct lawnmower will do the job better and safer at the rate for which it was designed.*
- i) Be aware of the mower and attachment discharge direction and do not point the mower discharge at anyone. *Thrown objects can cause personal injury.*
- j) Use extreme caution when reversing or pulling the lawnmower towards you. Always be aware of your surroundings. *This reduces the risk of tripping during operation.*
- k) When working on slopes, always be sure of your footing, always work across the face of slopes, never up or down and exercise extreme caution when changing direction. *This reduces the risk of loss of control, slipping and falling which may result in personal injury.*
- l) Operate the disabling device and/or remove all battery packs, if removable, from the lawnmower before making any adjustments, changing accessories, or storing the lawnmower. *Such preventive safety measures reduce the risk of starting the lawnmower accidentally.*

- m) Keep handles and grasping surfaces dry, clean and free from oil and grease. *Slippery handles and grasping surfaces do not allow for safe handling and control of the lawnmower in unexpected situations.*
- n) Check the grass catcher frequently for wear or deterioration. *A worn or damaged grass catcher may increase the risk of personal injury.*
- o) Before removing the grass catcher, turn off the motor and wait until the blade(s) comes to a complete stop. The cutting blade(s) continues to rotate after the blade control is released. Never place any part of the body in the blade(s) area until you are certain the motor is off and the blade(s) has stopped rotating. *Contact with the moving cutting blade(s) may result in serious personal injury.*
- p) Before unclogging the chute, turn off the motor, wait until the blade(s) comes to a complete stop, operate the disabling device and/or remove all batteries, if removable. The cutting blade(s) continues to rotate after the blade control is released. Never place any part of the body in the blade(s) area until you are certain the motor is off and the blade(s) has stopped rotating. *Contact with the moving cutting blade(s) may result in serious personal injury.*
- q) Before cleaning or inspecting the lawnmower, turn off the motor, wait until the blade(s) comes to a complete stop, operate the disabling device and/or remove all batteries, if removable. Accidental contact with the moving blade and moving parts may result in personal injury.
- r) Maintain the lawnmower and accessories. Check for misalignment or binding of moving parts, breakage of parts and any other condition that may affect the lawnmower's operation. If damaged, have the lawnmower repaired before use. *Many accidents are caused by poorly maintained lawnmowers.*
- s) Store idle lawnmowers out of the reach of children and do not allow persons unfamiliar with the lawnmower or these instructions to operate the lawnmower. *Lawnmowers are dangerous in the hands of untrained users.*

5) Battery lawnmower use and care

- a) Use lawnmowers only with specifically designated battery packs. *Use of any other battery packs may create a risk of injury and fire.*
- b) Recharge only with the charger specified by the manufacturer. *A charger that is suitable for one type of battery pack(s) may create a risk of fire when used with another battery pack(s).*
- c) Follow all charging instructions and do not charge the battery pack(s) or lawnmower outside the temperature range specified in

the instructions. *Charging improperly or at temperatures outside the specified range may damage the battery and increase the risk of fire.*

d) Do not use a battery pack or lawnmower that is damaged or modified. *Damaged or modified batteries may exhibit unpredictable behaviour resulting in fire, explosion or risk of injury.*

e) Do not expose a battery pack(s) or lawnmower to fire or excessive temperature. *Exposure to fire or temperature above 130 °C (265°F) may cause explosion.*

f) Under abusive conditions, liquid may be ejected from the battery(ies); avoid contact. If contact accidentally occurs, flush with water. If liquid contacts eyes, additionally seek medical help. *Liquid ejected from the battery(ies) may cause irritation or burns.*

g) When battery packs are not in use, keep them away from other metal objects, like paper clips, coins, keys, nails, screws or other small metal objects that can make a connection from one terminal to another. *Shorting the battery terminals together may cause burns or a fire.*

6) Service

a) Have your lawnmower serviced by a qualified repair person using only identical replacement parts. This will ensure that the safety of the lawnmower is maintained. *Use of parts which do not meet the original equipment specifications may lead to improper performance and compromise safety.*

b) Never service damaged battery packs. *Service of battery packs should only be performed by the manufacturer or authorized service providers.*

2.3 SAFETY FEATURES ON THE PRODUCT



WARNING

CAREFULLY READ AND UNDERSTAND THE SAFETY PRECAUTIONS BELOW BEFORE USING THE PRODUCT.

- Ensure that the safety hardware on the product is functioning properly before use.
- Regularly inspect the safety hardware, and if any defects are found, please contact your nearest service center immediately.

2.4 CHECK THE CUTTING DECK

The cutting deck is designed to reduce vibrations in the product and minimize the risk of injury from the blade.

- To ensure safe operation of the mower, it's important to inspect the cutting deck for any damages, such as cracks.

2.5 GRASS CATCHER

The grass catcher prevents injury to the operator from the rotating blade. The grass catcher wears during operation, so it is important to inspect it regularly for damages such as tears or holes. If there is any damage, replace it immediately with a grass catcher approved by the manufacturer.

2.6 BLADE ACTIVATION LEVER

- The blade activation lever starts the motor. When the lever is released, the motor stops.
- It's important to perform regular checks on the blade activation lever. To do this, power on the motor and then release the lever. If the motor doesn't stop within 3 seconds, there may be an issue with the lever. In this case, it's recommended to have an approved service center adjust the lever.

2.7 BATTERY SAFETY

Refer to the Battery Operator Manual for warning instructions before you use the product.

2.8 BATTERY CHARGER SAFETY

Refer to the Battery Charger Operator Manual for warning instructions before you use the product.

2.9 SAFETY INSTRUCTIONS FOR MAINTENANCE

- To prevent accidental start during maintenance, always turn off the product and remove the battery. Wait for at least 5 seconds before starting any maintenance work.
- Follow the maintenance instructions correctly to increase the product's lifetime and reduce the risk of accidents. Professional repairs must be done by a technician at an approved service center.
- Only perform the maintenance tasks listed in the operator's manual. Any other maintenance work should be done by a technician.
- Wear heavy-duty gloves when using the cutting equipment to prevent injuries from the sharp blade.
- Keep the cutting edges clean and sharp for optimal and safe performance.
- If you are experiencing difficulties with maintenance, have a service technician conduct regular inspections of the product and make any necessary adjustments and repairs.
- Replace any damaged, worn, or broken parts immediately.
- Follow the manufacturer's instructions when changing accessories. Only use accessories approved by the manufacturer.
- When not in use, store the product, battery, and battery charger in a dry, indoor, and locked area.

Keep the product, battery, and battery charger out of the reach of children and unauthorized persons.

Save these instructions

3 ASSEMBLY

This section describes how to assemble and adjust the product.

 **WARNING**

DO NOT USE PARTS OR ACCESSORIES THAT ARE NOT RECOMMENDED BY THE MANUFACTURER.

 **WARNING**

ENSURE THAT ALL PARTS ARE PROPERLY ASSEMBLED BEFORE INSERTING THE BATTERY.

 **WARNING**

READ AND UNDERSTAND THE SAFETY CHAPTER AND THE ASSEMBLY INSTRUCTIONS BEFORE YOU ASSEMBLE THE PRODUCT.

3.1 INSTALL THE UPPER HANDLE

1. Remove the rubber edge guard on top of the lower handle and discard it.

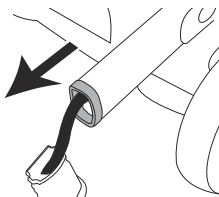

2. Next, remove the protective plastic film from the lower handlebars. Remove the EPE foam wrapped around the power cord.
3. Position the mower in a vertical position, as shown in the diagram below, to install the upper handle. The upper handle should be at the top of the handle shafts, hanging by a black control cable.

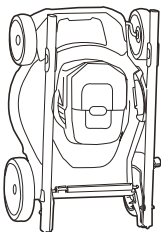

4. Carefully guide the control cable through the shafts while inserting the upper handle into the lower handle.

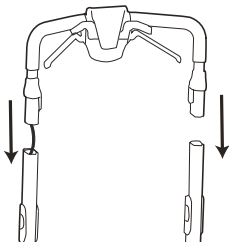

5. Insert the bolts through the holes and tighten the nuts using a Philips-head screwdriver (not included) to secure the handle in place.

**You can find bolts in the plastic bag hanging on the handlebar latch.*

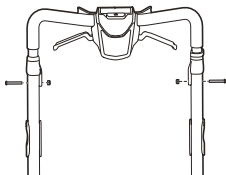

 **WARNING**

BE CAREFUL NOT TO PINCH, CRIMP, OR DAMAGE THE CONTROL CABLE WHEN INSTALLING THE HANDLE.

4 OPERATION

This section describes how to operate the product.



WARNING

CAREFULLY READ AND UNDERSTAND THE SAFETY CHAPTER AND OPERATION INSTRUCTIONS BEFORE YOU OPERATE THE PRODUCT.

4.1 BEFORE USING THE PRODUCT

4.1.1 BATTERY CAPACITY INDICATOR

The product has LED lights to indicate the battery level.

1. After installing the battery, the display will show the current battery level.

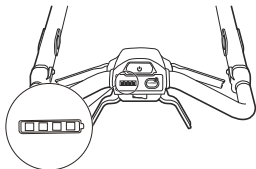

2. Please refer to the table for battery capacity.

Lights	Capacity
4 Green Lights	The battery is above 80% capacity
3 Green Lights	The battery is between 80% and 60% capacity
2 Green Lights	The battery is between 60% and 40% capacity
1 Green Light	The battery is between 40% and 20% capacity
No Green Light.	The battery is less than 20% capacity and requires charging immediately

4.1.2 CONNECT THE BATTERY CHARGER

1. Connect the battery charger to the proper voltage and frequency that is specified on the rating plate.
2. Refer to the Battery Charger Operator Manual for information about how to use the battery charger.

4.1.3 CHARGE THE BATTERY

Refer to the Battery Charger Operator Manual for information about how to use the battery charger.

4.1.4 BATTERY INFORMATION

Refer to the Battery Operator Manual for information about how to use the battery.

4.2 ADJUST THE HANDLEBAR POSITION

1. Simultaneously pull the 2 handlebar latches to release the handlebar lock.

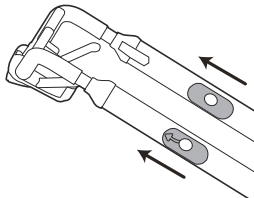

2. Lift the handlebar up until it locks into the mounting holes. Adjust to the position that is best suited to your height.

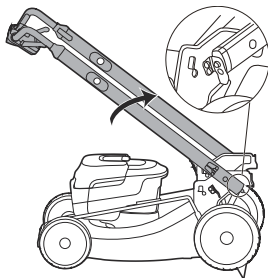

Note: Ensure that both handles are in the same position.

4.3 SET THE CUTTING HEIGHT

This lawn mower has eight different cutting height settings.

1. Move the cutting height lever out and backward to increase the cutting height.

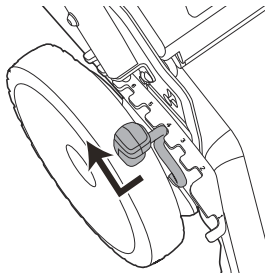

2. Move the cutting height lever out and forward to decrease the cutting height.

4.4 USE THE PRODUCT WITH GRASS CATCHER

1. Lift the rear door and remove the mulch plug.

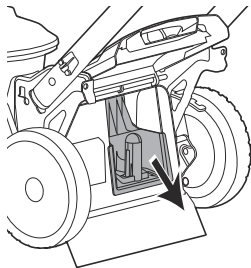

2. Hold the grass catcher by its handle and attach it securely to the mower using the hooks on the door rod.

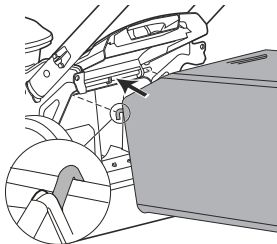

3. Release the rear door so that it rests on top of the grass bag frame.

4.5 SWITCH TO MULCHING MODE

Mulching mode cuts grass clippings into smaller pieces and disperses them back onto the lawn. The smaller grass clippings break down and provide natural fertilizer for the lawn. This mode eliminates the need to collect and dispose of grass clippings, making mowing more efficient and environmentally friendly.

1. Lift the rear door and remove the grass bag, if it is installed.
2. Insert the mulch plug into the rear grass chute.

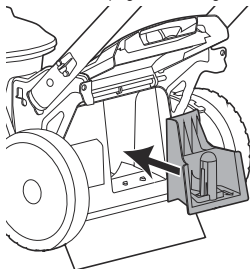

3. Close the rear door and ensure it is pressing against the mulch plug.

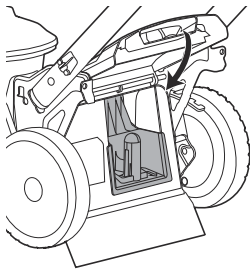

4.6 SWITCH TO SIDE DISCHARGING MODE



CAUTION

WHEN USING THE SIDE DISCHARGE CHUTE:

- DO NOT ATTACH THE GRASS CATCHER.
 - ENSURE THAT THE MULCH PLUG IS INSTALLED.
1. Locate the side discharge door and lift it open with one hand.
 2. With another hand, attach the side discharge chute by lining up the grooves on the side discharge chute with the pivot located on the underside of the cover.

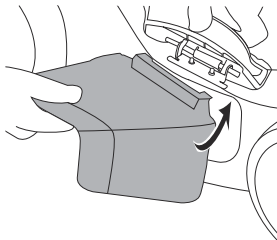

3. Lower the chute until the hooks on the mower deck are secured in the openings of the chute.

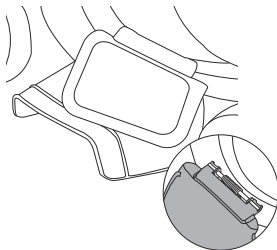

4. Close the side discharge cover.

4.7 MOWING WITHOUT A GRASS CATCHER OR MULCH PLUG

- Examine the rear door to make sure that there are no damages, such as cracks.
- If a mulch plug is attached, remove it.
- Close the rear door before you operate the product.

When you operate the product, the grass clippings will discharge below the rear cover.

4.8 CONNECT THE BATTERY TO THE PRODUCT

1. Open the battery door.
2. Align the ribs on the battery with the grooves in the battery compartment.
3. Push the battery into the battery compartment until the battery locks into place.

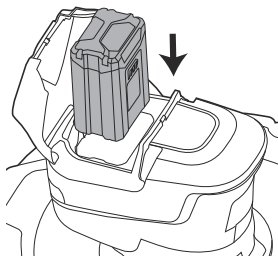

4. When you hear a click, the battery is installed.
5. Close the battery door.

4.9 START THE PRODUCT

1. Press and hold the power button. Then, grasp either of the blade activation levers towards the handle bar to engage the blades.

Note: Complete the two consecutive actions within 5 seconds.

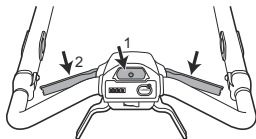

2. Once the product has started, you can release the power button.

4.10 ACTIVATE TURBO BOOST (TEMPORARILY INCREASED CUTTING SPEED)

1. Press the turbo button to increase the speed up to 3200 RPM.

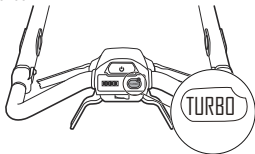

2. Release the turbo button to operate at the default cutting speed.

Note: *When using the turbo boost button, the battery will drain faster. Therefore, it is recommended to use the turbo boost button only when necessary.*

4.11 OPERATE THE SELF-PROPELLED DRIVE SYSTEM

4.11.1 SELF-PROPELLED DRIVING SYSTEM

1. While holding the blade activation lever, pull either of the drive levers towards the handlebar to engage the self-propelled driving system.

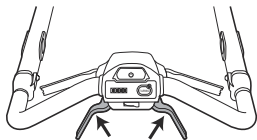

2. Release either set of start handle and drive lever from the same side.
3. Adjust the speed control with your free hand.

Note: *To sustain self-propelled mowing, continually hold the blade activation lever and drive lever from either the left or right side at the same time.*

- To increase the speed, slide the speed control switch towards the Rabbit Symbol.
- To decrease the speed, pull the speed control switch towards the Turtle Symbol.

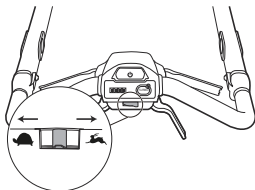

4. Release the drive lever to disengage the self-propelled driving system.

4.11.2 OPERATE WITHOUT MOWING

To engage the self-propelled driving system while the mower is not running:

- Press and hold the power button, then pull either of the drive levers towards the handlebar.

Note: *Complete the two consecutive actions within 5 seconds.*

4.12 LED HEADLIGHTS

1. The LED headlights will turn on when the device is switched on and will switch off when the device is switched off.

4.13 STOP THE PRODUCT

1. Release the blade activation lever(s) to stop the product.
2. Open the battery door.
3. Press the battery release button to remove the battery.

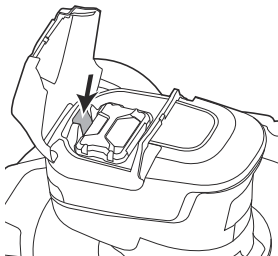



WAIT UNTIL THE BLADE HAS COMPLETELY STOPPED BEFORE RESTARTING THE PRODUCT. DO NOT QUICKLY TURN THE PRODUCT OFF AND ON.



ALWAYS TAKE OUT BATTERY AFTER FINISHING THE TASK.

4.14 RECOMMENDATIONS FOR EFFECTIVE LAWN MOWING

- Always use a sharp blade when mowing, as a dull blade can result in an uneven cut and cause the grass to turn yellow. Additionally, a sharp blade uses less energy than a dull one.
- Limit the amount of grass you cut to no more than one-third of its height. Start with a high cutting height and adjust it lower as needed after examining the results. If the grass is very long, mow slowly and consider making 2 passes if necessary.
- Vary the cutting direction each time you mow to prevent creating visible lines or stripes in the lawn.
- Keep the rear cover of the mower clean. Accumulation of grass and dirt on the inner side of the cutting cover can reduce the effectiveness of the cut.

5 MAINTENANCE

i IMPORTANT

Carefully read and understand the safety regulations and the maintenance instructions before you clean, repair, or do any maintenance on the product (Reference Safety regulations and maintenance instructions).

⚠ WARNING

- REMOVE BATTERY OR BATTERIES FROM THE PRODUCT BEFORE YOU DO ANY MAINTENANCE.
- FAILURE TO FOLLOW PROPER MAINTENANCE SERVICE, USING THIRD-PARTY REPLACEMENT PARTS, OR MODIFYING/REMOVING COMPONENTS CAN RESULT IN INJURY TO THE USER.

5.1 MAINTENANCE SCHEDULE

The maintenance intervals are calculated from daily use of the product. The intervals change if the product is not used daily.

	Each use	Monthly	Each season
Perform a general inspection of the product.	x		
Clean the product.	x		
Ensure that safety devices are not defective.	x		
Inspect the cutting equipment.	x		
Inspect the cutting deck.	x		
Inspect the blade engagement lever.	x		
Check that the power button is working correctly and not defective.	x		
Examine the battery for any damage.	x		
Ensure that the battery is charging properly.	x		
Check that the release buttons on the battery are working properly and that the battery locks into the product securely.	x		
Inspect the battery charger for any damage and ensure it is operating correctly.		x	
Check the connections between the battery and the product, as well as the connection between the battery and the battery charger.			x

5.2 GENERAL INSPECTION

- Check and tighten all nuts and screws on the product.
- Make sure to properly route and secure all cables to prevent them from being damaged.

5.3 CLEAN THE PRODUCT

Clean the product after each use with water, neutral detergent, and a soft cloth.

 CAUTION

- KEEP WATER AWAY FROM BATTERY COMPARTMENT WHILE WASHING TO AVOID DAMAGING THE ELECTRICAL COMPONENTS.
- DO NOT CLEAN WITH ALCOHOL, GASOLINE, ACETONE, OR OTHER CORROSIVE/VOLATILE SOLVENTS. THESE SUBSTANCES MAY DAMAGE THE EXTERNAL AND INTERNAL STRUCTURE OF YOUR MOWER.
- DO NOT RUB WITH SANDPAPER OR METAL BRUSH.

5.4 CLEAN THE BATTERY AND BATTERY CHARGER

 WARNING

DO NOT CLEAN THE BATTERY OR THE BATTERY CHARGER WITH WATER.

- Make sure that the battery and the battery charger and battery compartment are all clean and dry before you insert the battery into the battery charger.
- Clean the battery terminals with a soft and dry cloth.
- Clean the surface of the battery and the battery charger with a soft and dry cloth.

5.5 EXAMINE THE CUTTING EQUIPMENT

 WARNING

TO PREVENT ACCIDENTAL START, ALWAYS REMOVE THE BATTERY AND WAIT FOR AT LEAST 5 SECONDS.

 WARNING

WEAR HEAVY-DUTY PROTECTIVE GLOVES WHEN PERFORMING MAINTENANCE ON THE CUTTING EQUIPMENT. THE BLADE IS SHARP AND INJURIES CAN EASILY OCCUR.

Note: Make sure that both handlebar shafts are properly inserted into the mounting holes at the base of the mower. Ensure the shafts are in the same position.

- Examine the cutting equipment for damage or cracks. Always replace damaged cutting equipment.
- Inspect the blade to see if it is damaged or blunt.

5.5.1 REPLACE THE BLADES

 WARNING

SECURELY LOCK THE BLADES IN PLACE USING A WOODEN BLOCK TO PREVENT ANY POTENTIAL HARM TO YOUR FINGERS WHEN REPLACING THE BLADES. THE BLADES CAN BE MOVED WHEN THE MOTOR IS OFF AND FINGERS CAN BECOME TRAPPED BETWEEN THE BLADES AND STATIONARY PARTS.

Remove the Used Blades

1. Secure the blade using a wooden block for stabilization.

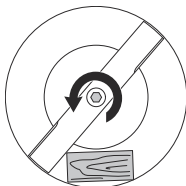

2. Remove the mounting screw and spacer with a 5/8 Inch (15mm) wrench or socket.
3. Carefully detach the blade(s) and fan.

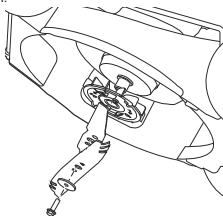

4. Inspect the fan, blade bolt, and base for any damage.
5. Examine the motor shaft to ensure it is not bent or damaged.

Install the New Blades

NOTE: The blade configuration of this mower is customizable. Dual blades provide the best cutting performance, while single blade offers extended runtime.

1. Reinstall the fan, followed by the new blade(s) (Dual blade: upper blade followed by mulching blade) positioning the angled ends of the mulching blade(jagged) upward toward the cutting cover.

*Dual blade order: Install upper blade (flat) then mulching blade (jagged edges)

*Single blade order: Install the mulching blade (jagged edges) **only**

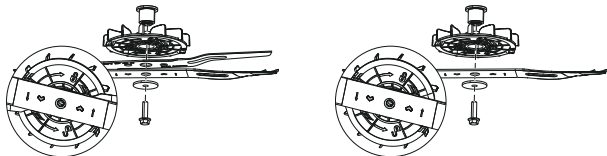

2. Ensure that the keyed holes on the blade(s) align with the indentations on the fan.
3. Secure the blade using a wooden block for stabilization. Insert the spacer and tighten the mounting screw to the recommended torque 26 ft.-lbs. (35 N.m.).

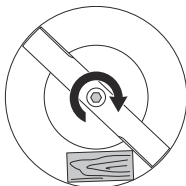

- Carefully rotate the blade(s) manually to ensure smooth spinning.
- Start the product and test the blade(s) to verify proper installation. Incorrect installation can result in vibrations or unsatisfactory cutting performance.

6 TRANSPORTATION, STORAGE, AND DISPOSAL

6.1 SET THE PRODUCT IN TRANSPORTATION POSITION

- Remove the grass catcher.
- Remove the battery.
- Pull the handlebar latch to fold the handles.

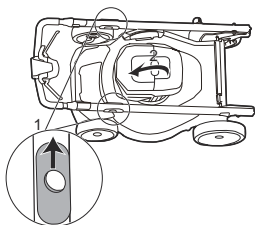

- Lock the handles into position.

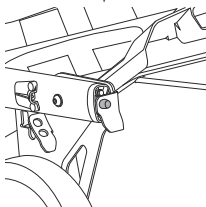

- Position the mower in a vertical position and make sure that the brackets touch the floor.

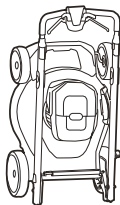

6.2 TRANSPORTATION

- Any removable (electronic) parts, such as the charger and battery, should always be disconnected before transport.
- Avoid transporting the product in bad weather conditions when possible.
- Make sure to adequately cover any exposed electronic parts if transportation in adverse weather conditions is unavoidable.
- Use tape on open contacts of the battery and ensure it is securely stowed to prevent movement.
- High speeds, along with wind, and rain may force moisture into the electronic components, which can lead to temporary malfunctions or permanent defects.
- In case of malfunction occurring after transport in such conditions, remove the battery and allow all parts to air-dry when you reach your destination.

6.3 DISPOSAL OF THE BATTERY, BATTERY CHARGER, AND PRODUCT

Symbols on the product or the package of the product mean that the product is not domestic waste. Recycle it at a recycling station for electrical and electronic equipment. This helps to prevent damage to the environment and persons.

Get in touch with your local authorities, domestic waste service, or your dealer for more information about how to recycle your product.

7 TROUBLESHOOTING

Problem	Possible cause	Solution
The handle is not in position.	The bolts are not engaged correctly.	Adjust the height of the handle and make sure that the bolts and nuts are aligned correctly.
The product does not start.	The battery capacity is low.	Charge the battery.
	The blade engagement lever is defective.	Replace blade engagement lever.
The product cuts grass unevenly.	The blade height is too low.	Move the wheels to a higher position.
The product does not mulch correctly.	Wet grass clippings become tangled in the deck.	Wait until the grass dries before mowing.
	The mulch plug is missing.	Install the mulch plug.
The product is hard to push.	The grass is too tall, or the blade height is too low.	Increase the blade height.
	The grass catcher and the blade drags in thick grass.	Empty the grass clippings from the grass catcher.
There is a high vibration in the product.	The blade is unbalanced and worn.	Replace the blade.
	The motor shaft is bent.	<ol style="list-style-type: none"> 1. Stop the motor. 2. Remove the battery. 3. Disconnect the power source. 4. Inspect for damage. 5. Repair the product before you start it again.
The product stops during mowing.	The blade height is too low.	Increase the blade height.
	The battery is out of power.	Charge the battery.
	The grass clippings become tangled in the deck or blade.	Remove the battery and check the deck.
	Operation temperature of the product is too high.	Turn off and move to shaded area for 10-15 minutes.

* If you cannot find the solution to these problems, consult your nearest service center.

8 TECHNICAL DATA

Voltage	60 V $\overline{---}$
Deck size	21" (53.3 cm)
Battery model	LB60251/LB6041/LB6042/ LB6051/LB6081 and other BAC series

Charger model	CAC801/CH60R00/ CH60DP01/60DPC10A and other CAC series
No load speed	2700 / 3200 RPM
Height adjustments	3/4 - 4" (2.0 - 10.2 cm)
Self-propelled speed	2.3 - 5.0 fps (0.7 - 1.5 m/s)

Functions	3-in-1 Mulch & Rear Bag & Side discharge
IPX	IPX4

Greenworks Tools Canada, Inc.

P.O. Box 93095, Newmarket, Ontario, L3Y 8K3

Mexico address:

TECNOLOGIA CAMPO Y JARDIN S.A. DE C.V.

ADMINISTRADORES No. 5336 A, COL. ARCOS DE GUADALUPE, ZAPOPAN, JALISCO, C.P. 45037

9 LIMITED WARRANTY



Greenworks hereby warrants this product, to the original purchaser with proof of purchase, for a period of four (4) years against defects in materials, parts or workmanship. Greenworks, at its own discretion will repair or replace any and all parts found to be defective, through normal use, free of charge to the customer. This warranty is valid only for units which have been used for personal use that have not been hired or rented for industrial/commercial use, and that have been maintained in accordance with the instructions in the operator manual supplied with the product from new.

ITEMS NOT COVERED BY WARRANTY:

1. Any part that has become inoperative due to misuse, commercial use, abuse, neglect, accident, improper maintenance, or alteration; or
2. The unit, if it has not been operated and/or maintained in accordance with the operator manual; or
3. Normal wear;
4. Routine maintenance items such as lubricants, blade sharpening;
5. Normal deterioration of the exterior finish due to use or exposure.

HELPLINE:

Warranty service is available by calling our toll-free helpline, at 1-855-345-3934.

TRANSPORTATION CHARGES:

Transportation charges for the movement of any power equipment unit or attachment are the responsibility of the purchaser. It is the purchaser's responsibility to pay transportation charges for any part submitted for replacement under this warranty unless such return is requested in writing by Greenworks.

USA address:

Greenworks Tools

P.O. Box 1238, Mooresville, NC 28115

Canadian address:

greenworks[®]

www.greenworkstools.com

