

greenworks®

SN80L01-00
SN80L410-00
SN80L41

EN	SNOW THROWER	OPERATOR MANUAL
FR	SOUFFLEUSE À NEIGE	MANUEL D'OPÉRATEUR
ES	EQUIPO QUITANIEVE	MANUAL DEL OPERADOR

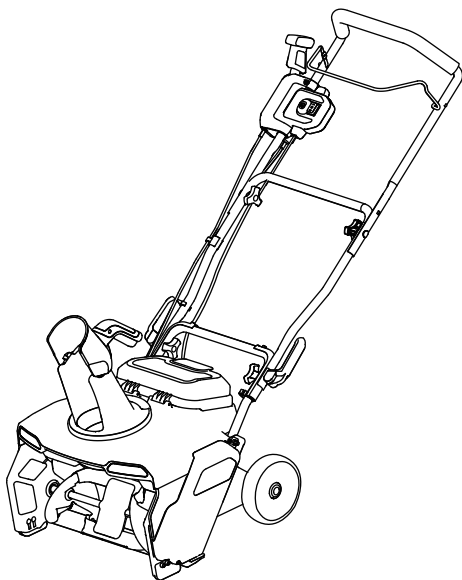

www.greenworkstools.com

1	Description.....	2	7.7	Remove the battery pack.....	7
1.1	Purpose.....	2	8	Operation.....	7
1.2	Overview.....	2	8.1	Cold weather operation.....	7
1.3	Symbols on the product.....	2	8.2	Start the product.....	7
1.4	California Proposition 65.....	2	8.3	Stop the machine.....	8
2	Safety.....	2	8.4	Adjust the discharge chute.....	8
2.1	Safety definitions.....	2	8.5	Adjust the chute deflector.....	8
2.2	Safe Operation Practices for Product.....	3	8.6	Operation tips.....	8
3	Safety features on the product.....	5	9	Maintenance.....	8
4	Safety instructions for maintenance.....	5	9.1	General maintenance.....	9
5	Environmentally safe battery disposal.....	5	9.2	Replace the scraper.....	9
6	Service.....	5	9.3	Replace the belt.....	9
7	Assembly.....	6	9.4	Replace the skid plates.....	10
7.1	Unpack the product.....	6	9.5	Store the machine.....	10
7.2	Install the middle handle.....	6	10	Troubleshooting.....	11
7.3	Install the upper handle.....	6	11	Technical data.....	11
7.4	Install the chute deflector.....	6	12	Recommended ambient temperature ranges.....	11
7.5	Install the chute control rod.....	6	13	Limited warranty.....	12
7.6	Install the battery pack.....	7	13.1	Items not covered by warranty.....	12
			13.2	Helpline.....	12
			13.3	Shipping.....	12

1 DESCRIPTION

1.1 PURPOSE

This machine is used to remove and clear away snow from sidewalks, driveways and other paved ground-level surfaces.

1.2 OVERVIEW

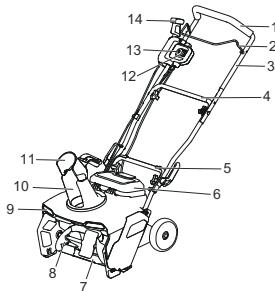

- 1 Handle bar
- 2 Bail lever
- 3 Upper handle
- 4 Middle handle
- 5 Lower handle
- 6 Battery door
- 7 Scraper
- 8 Impeller
- 9 LED lights
- 10 Discharge chute
- 11 Chute deflector
- 12 Speed button
- 13 Start button
- 14 Chute rotation handle

1.3 SYMBOLS ON THE PRODUCT

Symbol	Explanation
	Direct current
	Precautions that involve your safety.

Symbol	Explanation
	Read and understand all instructions before operating the product, and follow all warnings and safety instructions.
	Thrown objects can ricochet and result in personal injury or property damage. Wear protective clothing and boots.
	Keep bystanders a safe distance from the product.
	Keep hands away from the discharge area.
	Stay away from moving parts. Keep all guards and shields in place.
	Keep hands and feet away from the rotating impeller.
	Keep hands and feet away.
	Stop the motor and remove the battery before leaving the product.

1.4 CALIFORNIA PROPOSITION 65

WARNING

THIS PRODUCT CONTAINS OR EMITS A CHEMICAL KNOWN TO THE STATE OF CALIFORNIA TO CAUSE CANCER OR BIRTH DEFECTS OR OTHER REPRODUCTIVE HARM.

2 SAFETY

2.1 SAFETY DEFINITIONS

Warnings, cautions, and notes are used to point out especially important parts of the manual.

WARNING

THERE IS A RISK OF INJURY OR DEATH FOR THE OPERATOR OR BYSTANDERS IF THE INSTRUCTIONS IN THE MANUAL ARE NOT OBEYED.

 CAUTION

THERE IS A RISK OF DAMAGE TO THE PRODUCT, OTHER MATERIALS, OR THE ADJACENT AREA, IF THE INSTRUCTIONS IN THE MANUAL ARE NOT OBEYED.

Note: Used to give more information that is necessary in a given situation.

2.2 SAFE OPERATION PRACTICES FOR PRODUCT

 DANGER

This product has the potential to cause severe injury, including amputation of hands and feet, as well as the ejection of objects. Failure to adhere to the following safety instructions may lead to serious harm.

2.2.1 BATTERY TOOLS USE AND CARE

 WARNING

Read all safety warnings and instructions. Failure to follow the warnings and instructions may result in electric shock, fire and/or serious injury.

- Prevent unintentional starting. Ensure the switch is in the off-position before connecting to battery pack, picking up or carrying the product. Avoid carrying the product with your finger on the switch or powering it with your finger on the switch, as this can lead to accidents.
- Disconnect the battery pack from the product before making any adjustments, changing accessories, or storing product. Such preventive safety measures reduce the risk of starting the product accidentally.
- When battery pack is not in use, keep it away from other metal objects, like paper clips, coins, keys, nails, screws or other small metal objects, that can make a connection from one terminal to another. Shorting the battery terminals together may cause burns or a fire.
- Avoid contact with liquid that may be ejected from the battery under abusive conditions. If contact occurs, flush with water and seek medical help if it gets into the eyes. Ejected liquid from the battery can cause irritation or burns.
- Do not use a battery pack or product that is damaged or modified. Damaged or modified batteries may exhibit unpredictable behavior resulting in fire, explosion, or risk of injury.
- Do not expose a battery pack or product to fire or excessive temperature. Temperatures above 265 °F (130 °C) can cause explosion.

- Follow all charging instructions and do not charge the battery pack or product outside of the temperature range specified in the instructions. Charging improperly or at temperatures outside of the specified range may damage the battery and increase the risk of fire.
- For service or repairs, consult your nearest service center that will use identical replacement parts to ensure the safety of the product.
- Do not modify or attempt to repair the product or the battery pack (as applicable) except as indicated in the instructions for use and care.

2.2.2 FOR ALL PRODUCTS

- Do not use on grveled surfaces unless the product is adjusted for such a surface in accordance with the operator's manual.
 - Keep children away - Children and bystanders should remain at a safe distance while operating the product.
 - Dress Appropriately - Avoid wearing loose clothing or jewelry that can get caught in moving parts. It is recommended to wear protective footwear when using this product.
 - Operation of the product in the hand-held position is unsafe, except in accordance with the special instructions for such use provided in the operator's manual.
 - Keep hands away from moving parts.
 - Keep guards in place and in working order.
 - Avoid Overexerting the Product - The product performs better and safer when operated at its designated rate.
 - Don't Overreach – Keep proper footing and balance at all times
 - If the product strikes a foreign object follow these steps:
 1. Stop the product. Release the switch.
 2. Remove the battery pack.
 3. Inspect for damage.
 4. Repair any damage before restarting and operating the product.
 - Disconnect Product– Disconnect the product from the battery pack when not in use, before servicing, or changing accessories.
 - Store Idle Product Indoors – When not in use, products should be stored indoors in dry, locked-up place – out of reach of children.
 - Maintain Products With Care – Follow instructions for lubricating and changing accessories.
- ### 2.2.3 TRAINING
- Read the operating and service instruction manual carefully. Be thoroughly familiar with the controls

and the proper use of the product. Know how to stop the product and disengage the controls quickly.

- Ensure that only trained individuals operate the product, and never allow children to use it.
- Keep a clear area of operation, free from any individuals, especially small children and pets.
- Exercise caution to avoid slipping or falling, especially when operating in reverse.

2.2.4 PREPARATION

- Thoroughly inspect the area where the product is to be used and remove all doormats, sleds, boards, wires, and other foreign objects.
- Do not operate the product without wearing adequate winter garments. Wear protective footwear to improve footing on slippery surfaces.
- Adjust the collector housing height to clear gravel or crushed rock surface.
- Never attempt to make any adjustments while the product is running (except where specifically recommended by manufacturer).
- Always wear safety glasses or eye shields during operation or while making adjustments or repairs to protect eyes from foreign objects that may be thrown from the product.

2.2.5 OPERATION

- Do not put hands or feet near or under rotating parts. Keep clear of the discharge opening at all times.
- Exercise extreme caution when operating on or crossing gravel drives, walks, or roads. Stay alert for hidden hazards or traffic.
- If the product strikes a foreign object, turn the product off, remove the battery pack, and then inspect it for damage. Repair any damage before restarting and using the product.
- If the product should start to vibrate abnormally, stop the product and carefully inspect it. Vibration is generally a sign of trouble.
- Power off the product whenever you leave the operating position, before unlogging the collector/impeller housing or discharge guide, and when making any repairs, adjustments, or inspections.
- When cleaning, repairing, or inspecting, make certain the collector/impeller and all moving parts have stopped moving.
- Exercise extreme caution when operating on slopes.
- Never operate the product without proper guards, and other safety protective devices in place and in working order.
- Never direct the discharge toward people or areas where property damage can occur. Keep children and others away.
- Do not overload the product capacity by attempting to clear snow too quickly.

- Never operate the product at high transport speeds on slippery surfaces. Exercise caution when reversing.
- Make sure to power off when the product is transported or not in use.
- Use only attachments and accessories approved by the manufacturer (such as wheel weights, counterweights, or cabs).
- Never operate the product without good visibility or light. Always be sure of your footing, and keep a firm hold on the handles. Walk, don't run.
- Never use your body parts to clear the discharge chute.
- Sudden contact with the rotating impeller inside the discharge chute is the most common cause of injury associated with products. Never use your hand to clean out the discharge chute.

To clear the chute:

1. SHUT THE PRODUCT OFF!
2. Wait 10 seconds to be sure the impeller blades have stopped rotating.
3. Always use a clean-out tool, not your hands.

2.2.6 MAINTENANCE AND STORAGE

- Check shear bolts and other bolts before and after every use for proper tightness to be sure the product is in safe working condition.
- Always refer to owner's guide instructions for important details if the product is stored for an extended period.
- Maintain or replace safety and instructions labels, as necessary.
- Run the product a few minutes after throwing snow to prevent freeze-up of the collector/impeller.

2.2.7 RECOMMENDED AMBIENT TEMPERATURE RANGES:

Situation	Temperature
Product storage	1.4°F (-17°C) ~ 113°F (45°C)
Product operation	1.4°F (-17°C) ~ 113°F (45°C)
Battery charging	39°F (4°C) ~ 104°F (40°C)
Charger operation	39°F (4°C) ~ 104°F (40°C)
Battery discharging	1.4°F (-17°C) ~ 113°F (45°C)
Battery storage	32°F (0°C) ~ 113°F (45°C)

3 SAFETY FEATURES ON THE PRODUCT

 WARNING**CAREFULLY READ AND UNDERSTAND THE SAFETY PRECAUTIONS BELOW BEFORE USING THE PRODUCT.**

- Ensure that the safety hardware on the product is functioning properly before use.
- Regularly inspect the safety hardware, and if any defects are found, please contact your nearest service center immediately.

4 SAFETY INSTRUCTIONS FOR MAINTENANCE

- Make sure to stop the motor before you do any maintenance on the product.
- Impeller blades are sharp. Wear protective gloves when doing any blade maintenance.
- Only use accessories that have been approved by the manufacturer. Do not modify the product in any way. Using unofficial or third-party accessories can result in serious injury or death.
- Failure to perform maintenance correctly and regularly increases the risk of injury and damage to the product.
- Only carry out maintenance tasks as outlined in the operator's manual. All other servicing should be performed by an authorized service center.
- Regular servicing of the product should be carried out by an approved service center.
- Replace any damaged, worn, or broken parts promptly to maintain the safety and functionality of the product.

Save these instructions

5 ENVIRONMENTALLY SAFE BATTERY DISPOSAL



The toxic and corrosive materials below are in the batteries used in this product: **Lithium-ion, a toxic material.**

 WARNING

Discard all toxic materials in a specified manner to prevent contamination of the environment. Before discarding damaged or worn-out Lithium-ion batteries, contact your local waste disposal agency, or the local Environmental Protection Agency for information and specific instructions. Take the batteries to a local recycling and/or disposal center, certified for Lithium-ion disposal.

 WARNING

If the battery cracks or breaks, with or without leaks, do not recharge it and do not use. Discard it and replace with a new battery. **DO NOT TRY TO REPAIR IT!** To prevent injury and risk of fire, explosion, or electric shock, and to avoid damage to the environment:

- Cover the terminals of the battery with heavy-duty adhesive tape.
- DO NOT try to remove or destroy any of the battery components.
- DO NOT try to open the battery.
- If a leak develops, the released electrolytes are corrosive and toxic. DO NOT get the solution in the eyes or on skin, and do not swallow it.
- DO NOT put these batteries in your regular household trash.
- DO NOT incinerate.
- DO NOT put them where they will become part of any waste landfill or municipal solid waste stream.
- Take them to a certified recycling or disposal center.

6 SERVICE

Service requires extreme care and knowledge, and must be performed only by a qualified service technician. Consult your nearest **AUTHORIZED SERVICE CENTER** for repair. Call 1-855-345-3934 to obtain the address. Only use identical manufacturer's replacement parts and accessories from the **AUTHORIZED SERVICE CENTER**.

7 ASSEMBLY

7.1 UNPACK THE PRODUCT



WARNING

MAKE SURE THAT YOU CORRECTLY ASSEMBLE THE PRODUCT BEFORE USE.



WARNING

- IF PARTS OF THE PRODUCT ARE DAMAGED, DO NOT USE THE PRODUCT.
- IF PARTS ARE MISSING, DO NOT OPERATE THE PRODUCT.
- IF PARTS ARE DAMAGED OR MISSING, CONTACT THE SERVICE CENTER.

1. Open the package.
2. Read the documentation provided in the box.
3. Remove all the unassembled parts from the box.
4. Remove the product from the box.
5. Discard the box and packing material in compliance with local regulations.



WARNING

FOR YOUR PERSONAL SAFETY, DO NOT POWER ON BEFORE THE PRODUCT IS ASSEMBLED COMPLETELY.

7.2 INSTALL THE MIDDLE HANDLE

1. Align the holes in the middle handle and the lower handle.
2. Insert the bolt at the lower end of the handle through the mounting hole and tighten it with the handle knob. Snap the upper end of the handle onto the middle handle.

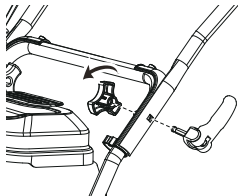

3. Repeat for left/right side.

7.3 INSTALL THE UPPER HANDLE

1. Align the holes in the middle handle and the upper handle.

2. Put the bolts (3) through the holes.

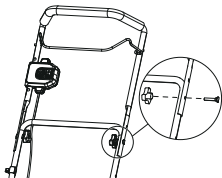

3. Tighten the handle knobs (4) onto the bolts (3).
4. Do the same operation on the other side.

7.4 INSTALL THE CHUTE DEFLECTOR

1. Align the grooves (1) of the discharge chute with the slot (2) on the chute housing.

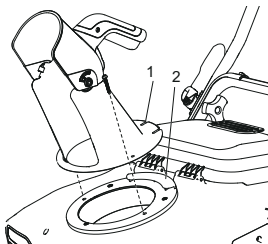

2. Push the discharge chute into position.
3. Tighten the screws with a screw driver to secure the discharge chute.

7.5 INSTALL THE CHUTE CONTROL ROD

1. Align the holes in the panel of the chute-rotation box and the switch box.
2. Thread the screws into the holes and tighten the nuts with a wrench (not included).

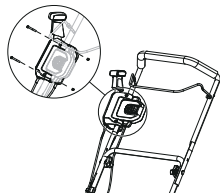

7.6 INSTALL THE BATTERY PACK

▲ WARNING

- IF THE BATTERY PACK OR CHARGER IS DAMAGED, REPLACE THE BATTERY PACK OR THE CHARGER.
- STOP THE MACHINE AND WAIT UNTIL THE ENGINE STOPS BEFORE YOU INSTALL OR REMOVE THE BATTERY PACK.
- READ, KNOW, AND FOLLOW THE INSTRUCTIONS IN THE BATTERY AND CHARGER MANUAL.

1. Open the battery door.
2. Align the ribs on the battery pack with the grooves in the battery compartment.
3. Push the battery pack into the battery compartment until the battery pack locks into place. When you hear a click, the battery pack is installed.

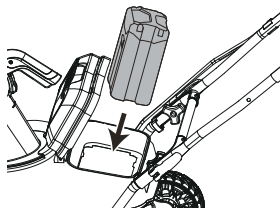

4. Close the battery door.

7.7 REMOVE THE BATTERY PACK

1. Open the battery door.
2. Push and hold the battery release button.
3. Remove the battery pack from the machine.

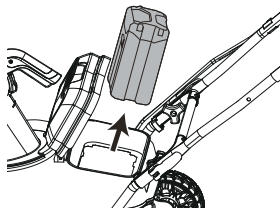

8 OPERATION

▲ WARNING

EYE PROTECTION MUST BE WORN WHEN OPERATING THIS MACHINE.

i NOTE

IT IS RECOMMENDED TO WEAR STURDY, FULLY ENCLOSED, SAFETY FOOTWEAR WITH GOOD GRIPS WHEN OPERATING THIS MACHINE.

8.1 COLD WEATHER OPERATION

The safe battery operation temperature ranges from 1°F (-17°C) to 113°F (45°C).

▲ WARNING

DO NOT STORE OR CHARGE BATTERY OUTSIDE.

Battery must be charged and stored indoors before using the product.

If the product does not start:

1. Remove the battery from the product.
2. Charge the battery for up to 15 minutes in a warm area, or until the charging light turns green.
3. Reinstall the battery in the unit.

8.2 START THE PRODUCT

1. While holding the start button, pull the bail lever to start the product.

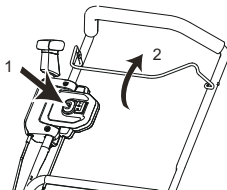
**▲ WARNING**

KEEP BYSTANDERS A SAFE DISTANCE FROM THE MACHINE.

▲ WARNING

INSPECT THE WORK AREA. REMOVE ALL STONES, STICKS, WIRE, BONES, AND OTHER DEBRIS THAT CAN RICOCHET BECAUSE OF THE ROTATING IMPELLER.

8.3 STOP THE MACHINE

1. Release the bail lever to stop the machine.

▲ WARNING

Wait until the impeller fully stops before you start the machine again. Do not quickly turn the machine off and on.

▲ WARNING

Remove the battery after you complete the work.

8.4 ADJUST THE DISCHARGE CHUTE

You can adjust the discharge chute 180° to change the snow direction.

1. Turn the grip handle backward to move the discharge chute to the right.

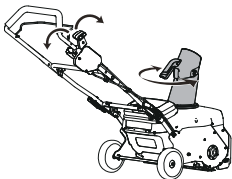

2. Turn the grip handle forward to move the discharge chute to the left.

8.5 ADJUST THE CHUTE DEFLECTOR

You can adjust the chute deflector up and down to change the throwing distance of the snow.

▲ WARNING

RELEASE THE BAIL SWITCH BEFORE YOU ADJUST THE CHUTE DEFLECTOR.

▲ WARNING

DO NOT PUSH THE DEFLECTOR SO FAR FORWARD THAT A GAP SHOWS BETWEEN THE DEFLECTOR AND THE CHUTE.

1. Push and hold the trigger (1) on the chute deflector.
2. Move the chute deflector up to increase the snow distance.

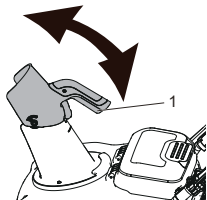

3. Move the chute deflector down to decrease the snow distance.

8.6 OPERATION TIPS

- If it is possible, clear the snow with the direction of the wind.
- In strong winds, lower the chute deflector to direct the snow to the ground.
- When you complete the work, let the machine operate for a while to prevent ice formation in the discharge chute.
- If the snow is deeper than 8", decrease the speed and let the machine work at its own rhythm.
- Do not use the scraper to remove compact snow and ice.

9 MAINTENANCE

▲ WARNING

Remove the safety key and battery pack from the machine before maintenance.

▲ CAUTION

Use only approved replacement parts.

▲ CAUTION

Do not let brake fluids, gasoline, petroleum-based materials touch the plastic parts. Chemicals can cause damage to the plastic, and make the plastic unserviceable.

▲ CAUTION

Do not use strong solvents or detergents on the plastic housing or components.

9.1 GENERAL MAINTENANCE

- Before each use, examine the machine for damaged, missing, or loose parts such as screws, nuts, bolts and caps.
- Tighten all the fasteners and caps correctly.
- Clean the remaining snow on the machine with a brush.

9.2 REPLACE THE SCRAPER

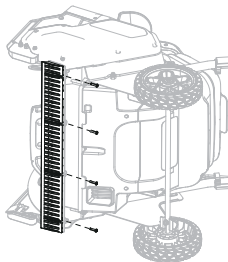

⚠ WARNING

USE ONLY APPROVED REPLACEMENT SCRAPERS.

⚠ WARNING

WEAR HEAVY GLOVES AROUND THE BLADE WHEN YOU TOUCH THE BLADE.

⚠ WARNING

THE SCRAPER IS LOCATED AT THE BOTTOM OF THE IMPELLER HOUSING. ENSURE THAT THE BATTERY IS NOT INSTALLED IN THE TOOL.

1. Turn the machine to its side.
2. Remove the 4 bolts below the deck that secure the scraper to the product.
3. Remove the worn scraper from the product and replaced with the new one.
4. Install and tighten the bolts that you removed.

9.3 REPLACE THE BELT

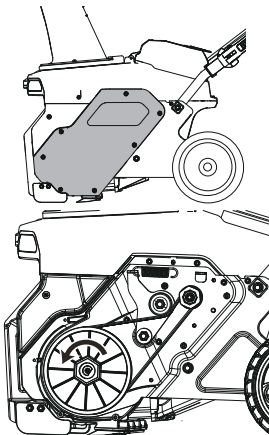

⚠ WARNING

MAKE SURE TO TURN OFF THE BAIL LEVER AND REMOVE THE BATTERY PACK(S) BEFORE PERFORMING ANY MAINTENANCE TASK ON YOUR SNOW THROWER.

1. Remove the screws on the left side plate.
2. Turn the large pulley counterclockwise while you remove the remaining belt.
3. Turn the new belt onto the pulleys.
4. Install and tighten the screws that you removed.

9.4 REPLACE THE SKID PLATES

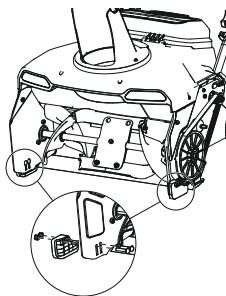

i NOTE

THE RANGE OF ADJUSTABLE HEIGHT FOR SKID PLATES IS 0-18MM, WHICH CAN BE ACHIEVED BY THREADING THE BOLTS INTO DIFFERENT MOUNTING HOLE POSITIONS.

1. Loosen the 2 sets of bolts and nuts securing the skid plates to the snow thrower housing.
2. Remove the skid plate, and replace it with the new one.
3. Do the same operation on the other side.

9.5 STORE THE MACHINE

- Remove the safety key.
- Remove the battery pack(s).
- Clean the machine before storage.
- Make sure the motor is not hot when you store the machine.
- Make sure that the machine does not have loose or damaged parts. If it is necessary, follow these instructions:
 - Replace the damaged parts.
 - Tighten the bolts.
 - Speak to a person at an approved service center.
- Store the machine in a dry area.
- Make sure that children cannot come near the machine.

10 TROUBLESHOOTING

Problem	Possible cause	Solution
The handle is not in position.	The bolts are not installed correctly.	Adjust the height of the handle and make sure that the knobs and bolts are aligned correctly.
The product does not start.	The battery is not charged.	Charge the battery by following the procedures in the Battery and Charger manual.
	The switch is defective.	Have the switch replaced by an authorized service center.
	Battery is too cold.	Remove battery from snow thrower. Place battery on charger and allow to charge for 10 minutes or until the charging light turns green. Remove from charger and install in snow thrower for use.
	Blue LED light is Flashing - Battery is in Low Voltage Protection.	The blue LED icon will flash if the battery voltage is low. To resolve this issue, place the battery at room temperature and initiate charging. Charge the battery until the LED light on the battery indicator flashes green.
	Blue LED light is always on - Battery Temperature is Low.	The blue LED icon will remain on if the battery temperature is too low. To resolve this issue, bring both the battery and charger into a warm area. Place the battery in the charger and allow it to reach room temperature. Once the battery indicator flashes green, remove the battery from the charger, insert it into the battery compartment, and begin your work.
	Battery may require service or replacement.	Please contact the authorized after-sales service center.
The product is on, but the auger does not rotate.	The belt is damaged.	Replace the belt.
A thin layer of snow stays behind.	The scraper bar is damaged.	Replace the scraper bar.

*If you cannot find the solution to these problems, please contact the authorized after-sales service center.

11 TECHNICAL DATA

Voltage	80 V DC
No load speed	1900/2200/2500 RPM
Clearing width	20 in.
Clearing depth	10 in.
Impeller size	10 in.
Battery	BAB742 and other BAB series
Charger	CAB809 and other CAB series

12 RECOMMENDED AMBIENT TEMPERATURE RANGES

Situation	Temperature
Product storage	1.4°F (-17°C) ~ 113°F (45°C)
Product operation	1.4°F (-17°C) ~ 113°F (45°C)
Battery charging	39°F (4°C) ~ 104°F (40°C)
Charger operation	39°F (4°C) ~ 104°F (40°C)
Battery discharging	1.4°F (-17°C) ~ 113°F (45°C)
Battery storage	32°F (0°C) ~ 113°F (45°C)

13 LIMITED WARRANTY

Greenworks products and batteries are protected against all defects in materials, parts, or workmanship under normal use for a period of 3 years from the shipping date or in-store purchase date.

At its own discretion, **Greenworks** can opt to repair, replace, substitute with a comparable item, or issue a refund for products that are determined to be defective through normal use or that have been damaged during shipment. Proof of purchase and product registration is required. Replacement of products or parts subject to normal wear and tear is the responsibility of the customer.

This warranty is valid only for units which have been maintained in accordance with the instructions found in the operator manual supplied with the product; and for units which have been registered in one of the following ways:

Online: www.greenworkstools.com

Phone – 1-855-345-3934

If **Greenworks** accepts a return under warranty, you can return the defective or damaged product only after you call our Customer Care team and receive a Return Authorization from **Greenworks**. You will also receive a refund for your original shipping charges, and **Greenworks** will arrange and pay for your return shipping charges. To request a Return Authorization, please contact us at 1-855-345-3934.

13.1 ITEMS NOT COVERED BY WARRANTY

- Any part that has become inoperative due to misuse, commercial use, abuse, neglect, accident, improper maintenance, or alteration.
- The unit, if it has not been operated and/or maintained in accordance with the operator manual.
- Normal wear, except as noted below:
 - Routine maintenance items such as lubricants.
 - Normal deterioration of the exterior finish due to use or exposure.
 - Any part/product, that has become inoperable due to use with any non-**Greenworks**-branded parts or batteries/chargers.

13.2 HELPLINE

Warranty service is available by calling our toll-free helpline at: 1-855-345-3934.

13.3 SHIPPING

Transportation charges for the movement of any power equipment unit or attachment are the responsibility of the purchaser. It is the purchaser's responsibility to pay transportation charges for any part submitted for replacement under this warranty unless such return is requested in writing by **Greenworks**.

13.3.1 ADDRESS

USA address:

Greenworks North America, LLC
P.O. Box 1238 , Mooresville, NC 28115, USA

Canada address:

Greenworks Tools Canada, Inc.
67 Toll Rd., Holland Landing, ON L9N 1H2

greenworks[®]

www.greenworkstools.com



P0806937-00